

# ROZMIESZCZENIE I SCHEMATY MEBLI DLA 1H\_1

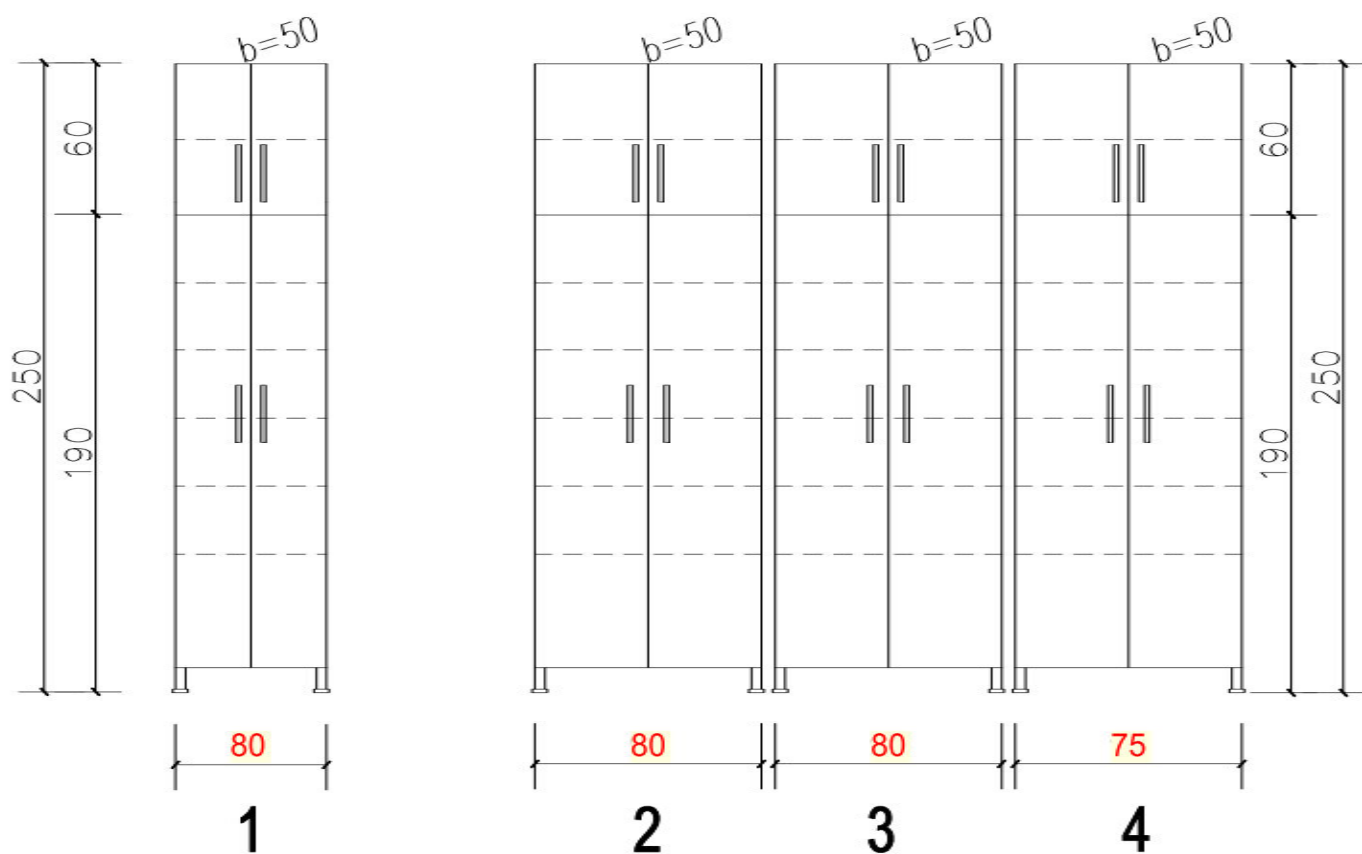

# 1219

## Zmywalnia Butelek

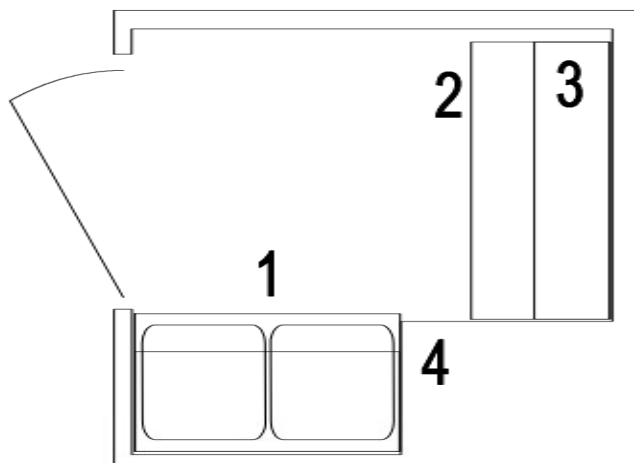

1218  
Pomieszczenie Mycia i Dezynfekcji

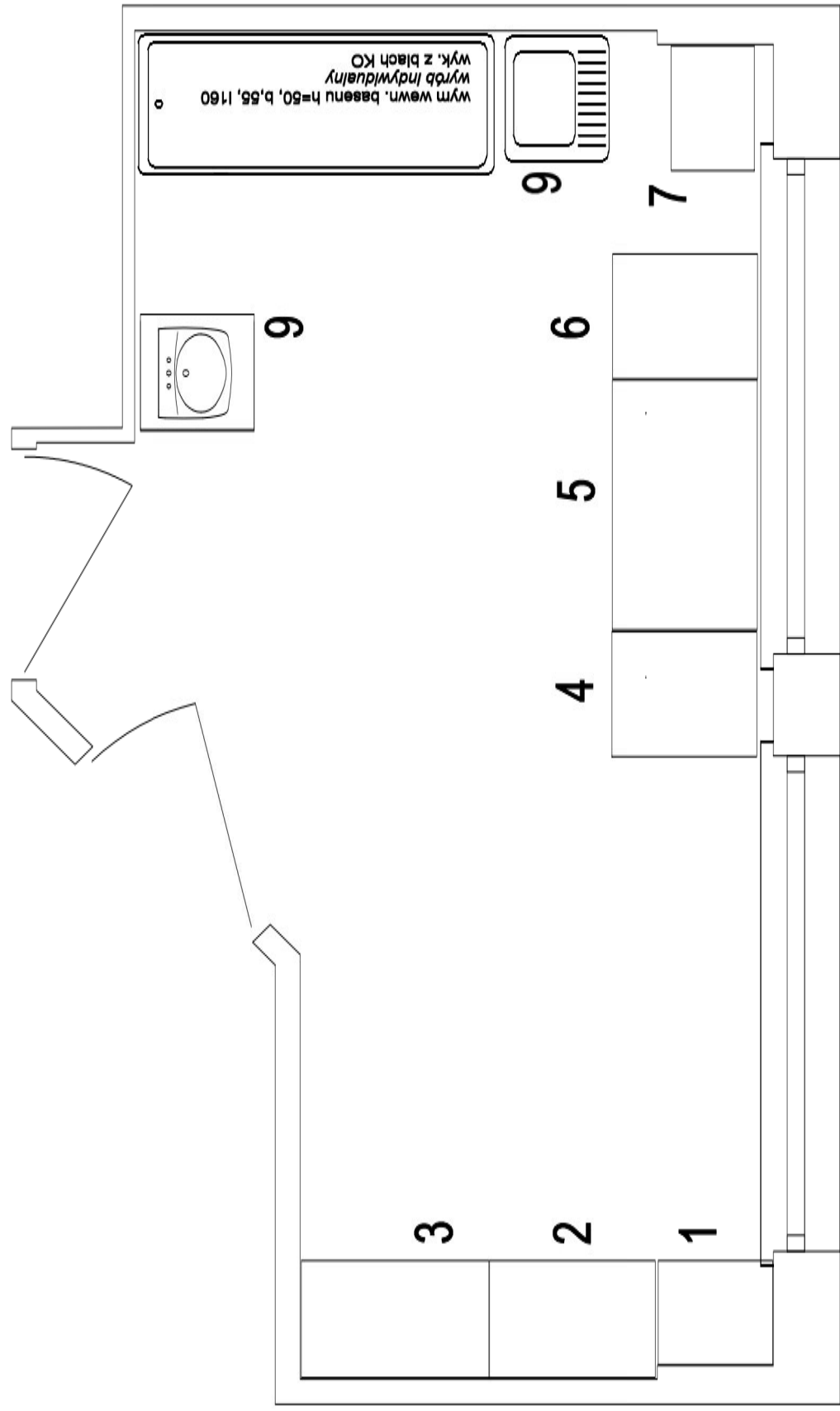

# ROZMIESZCZENIE I SCHEMATY MEBLI DLA 1H\_1

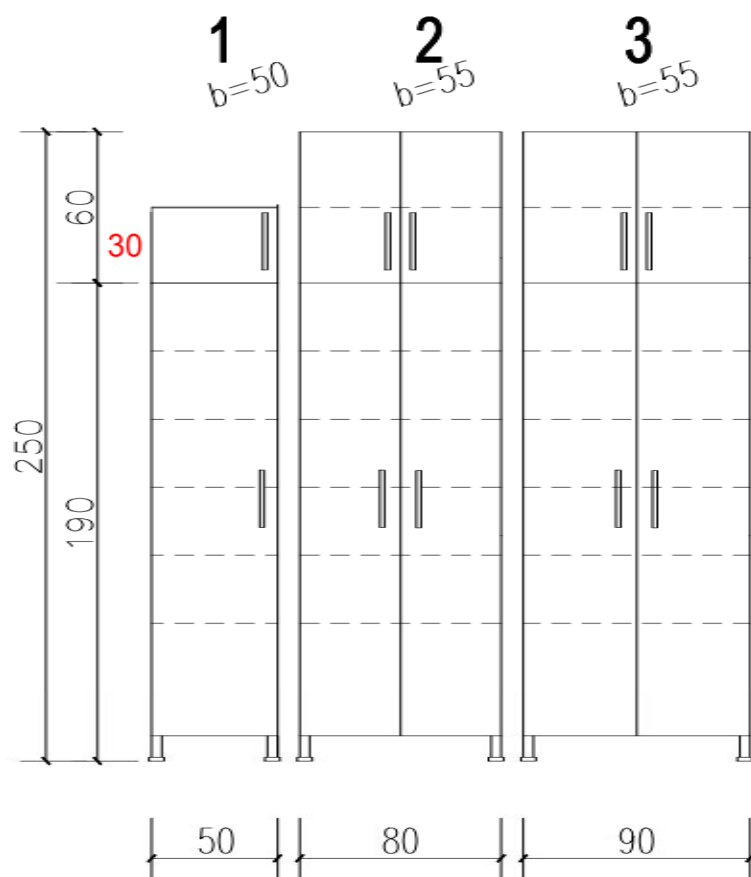

1218

Pomieszczenie Mycia  
i Dezynfekcji

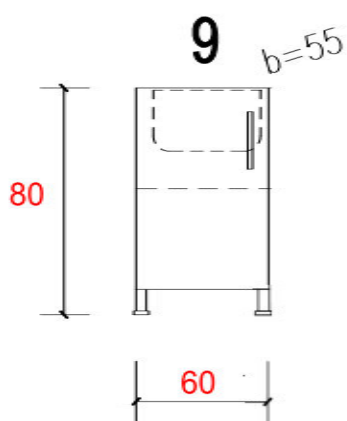
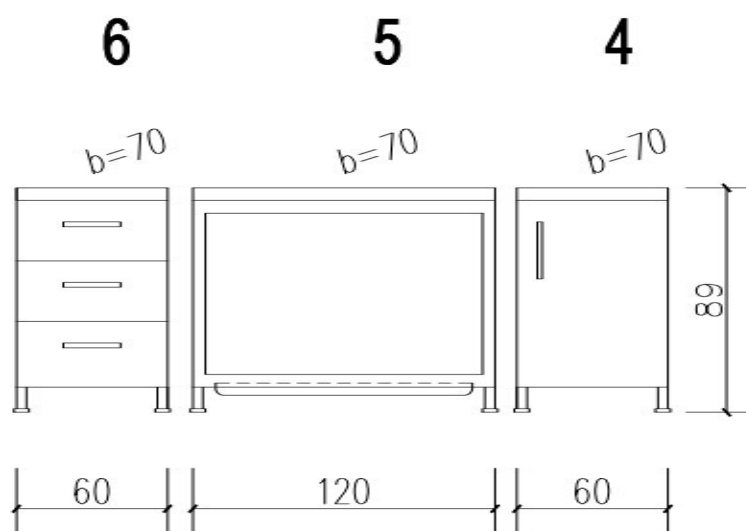
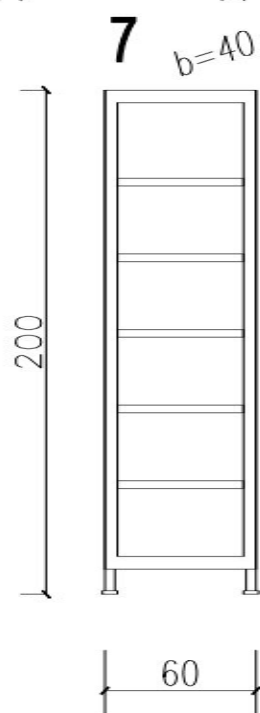

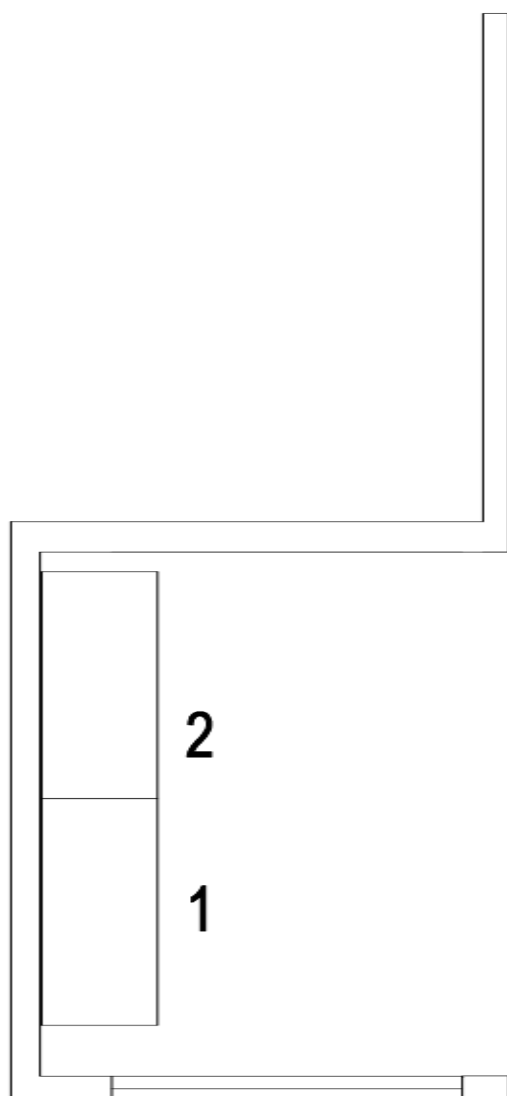

**1221A**  
**Pomieszczenie do**  
**Przechowywania**  
**i Podgrzewania Mleka**

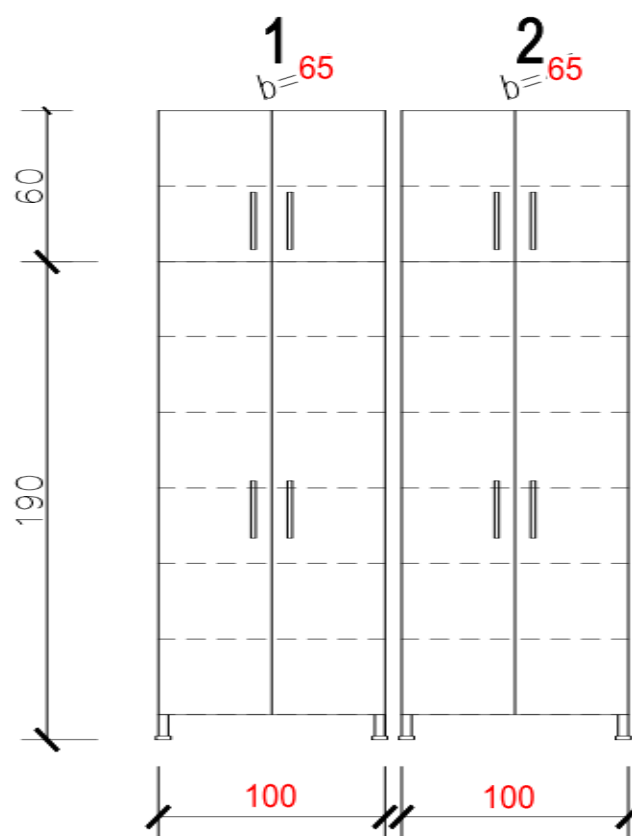

# 1221C

## Pomieszczenie Porządkowe

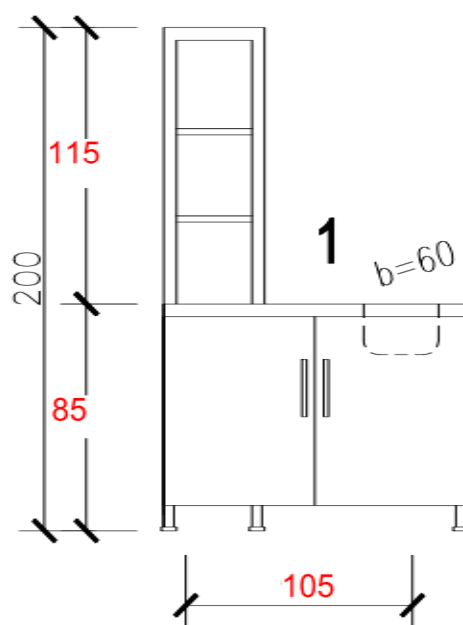
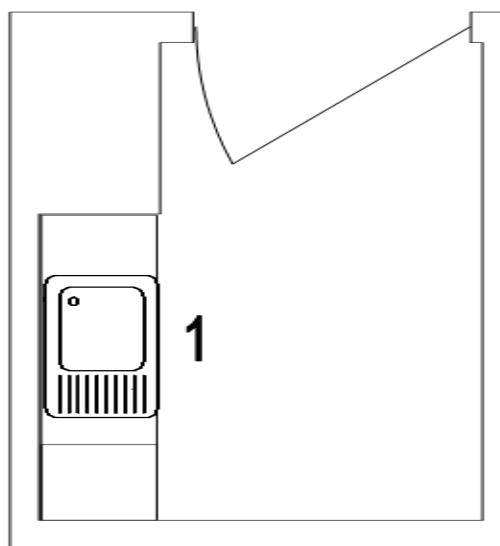

## ROZMIESZCZENIE I SCHEMATY MEBLI DLA 1H\_1

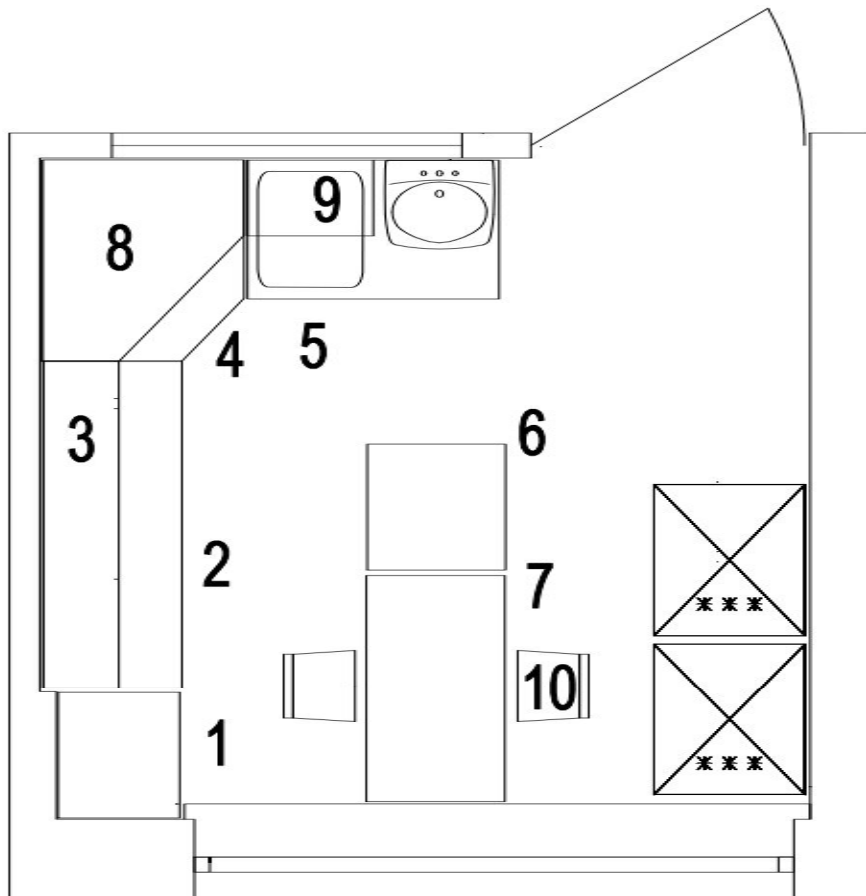

1221B  
Kuchnia Mleczna

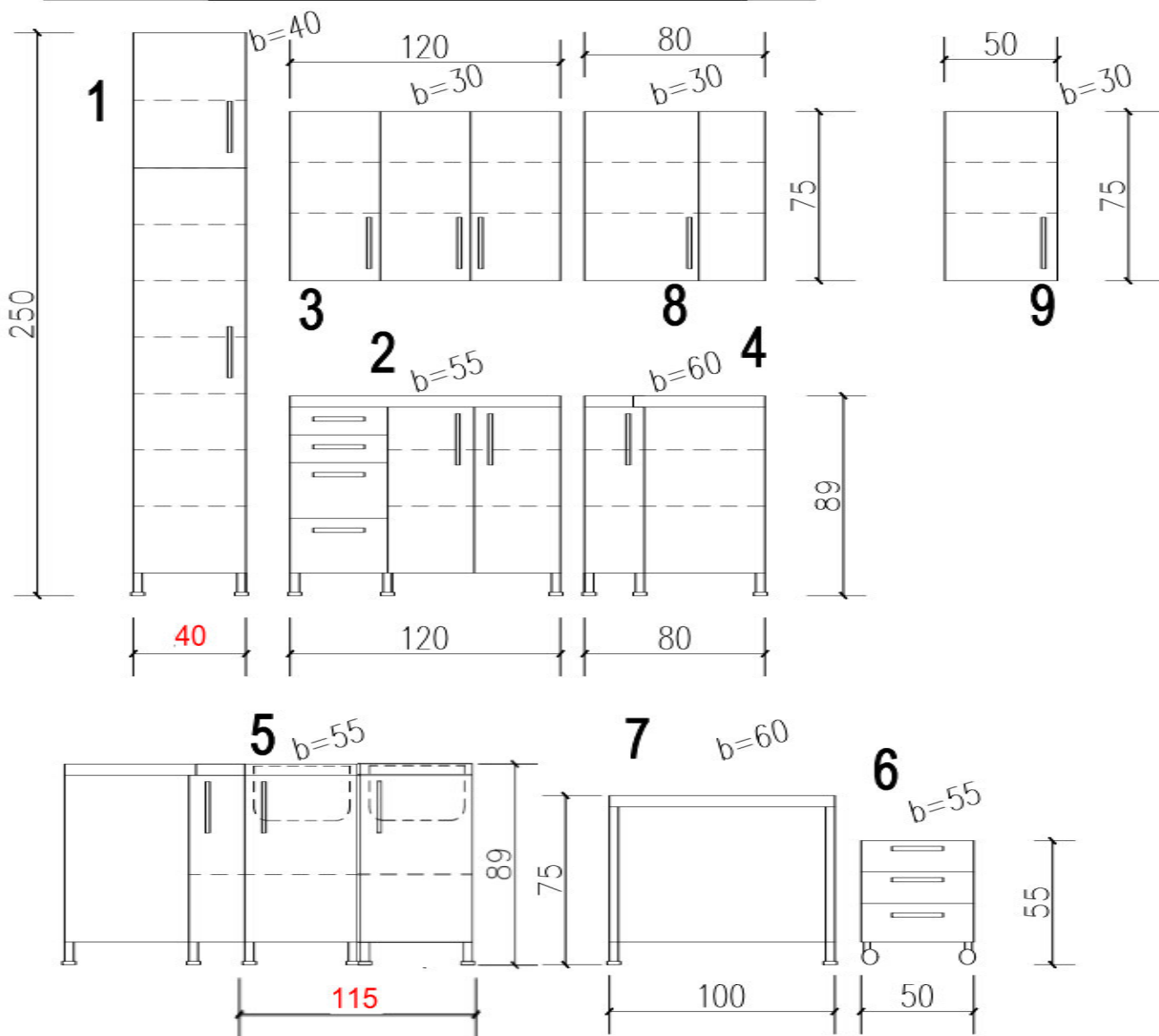

**1222B**  
**Pokój Lekarski**

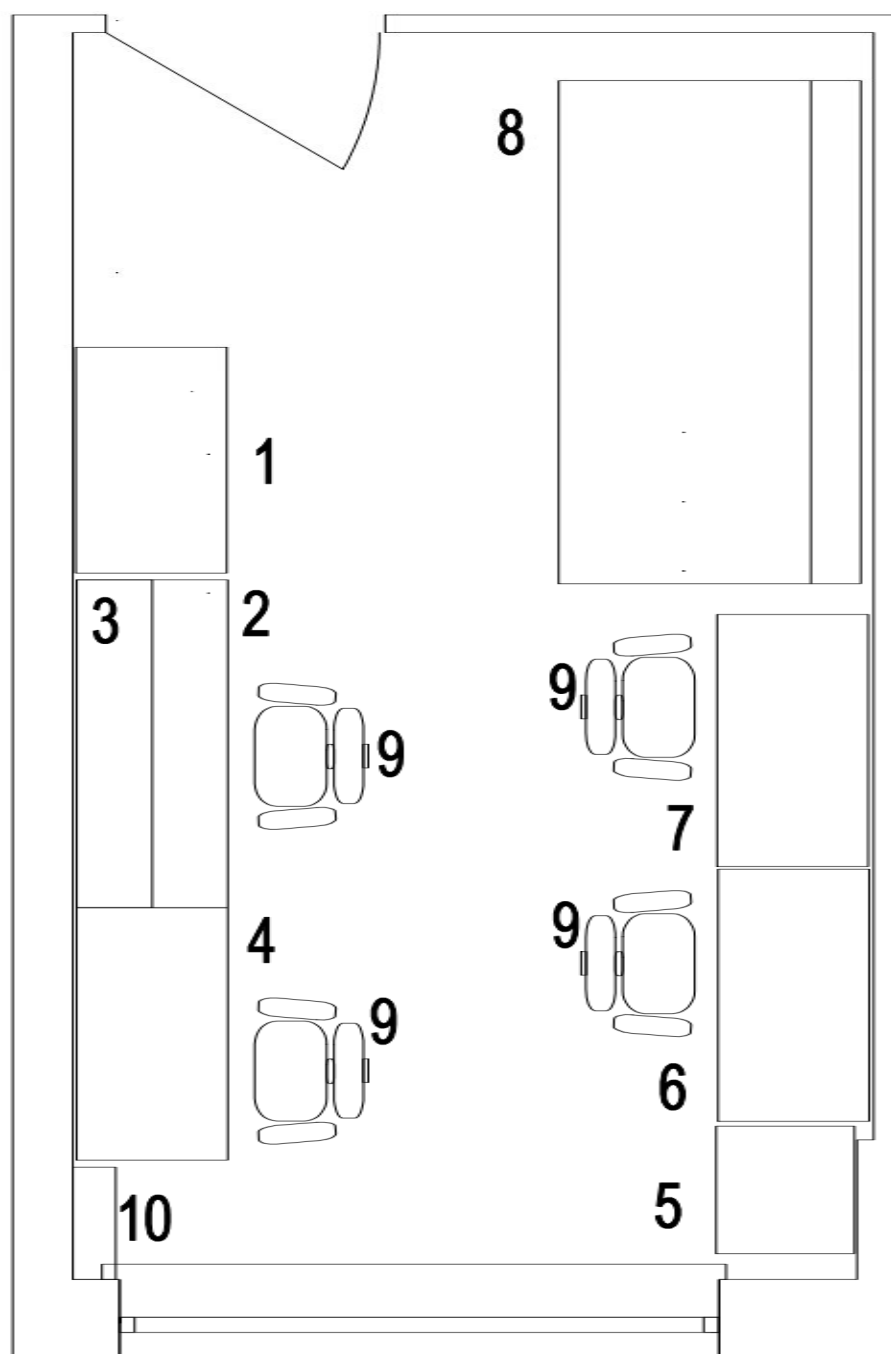



# ROZMIESZCZENIE I SCHEMATY MEBLI DLA 1H\_1

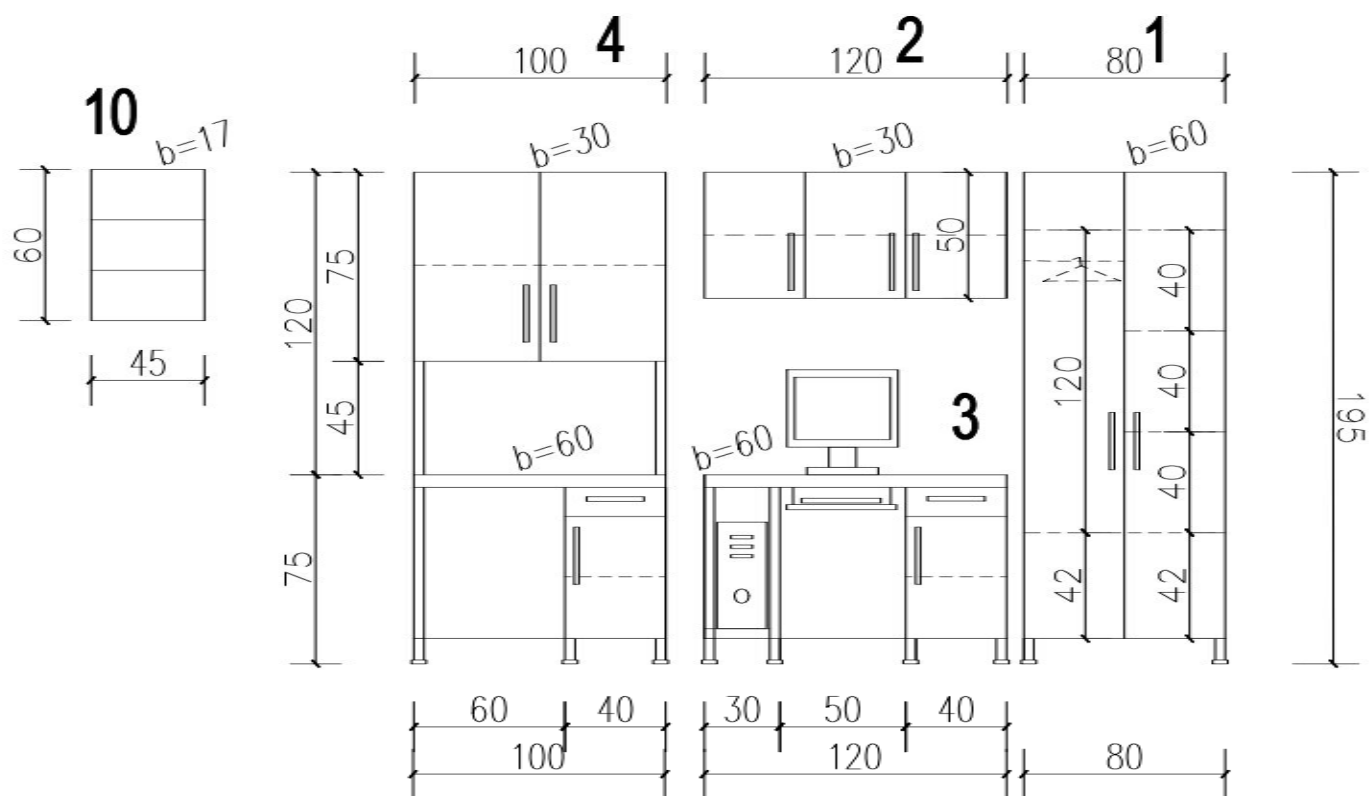

**1222B**  
**Pokój Lekarski**

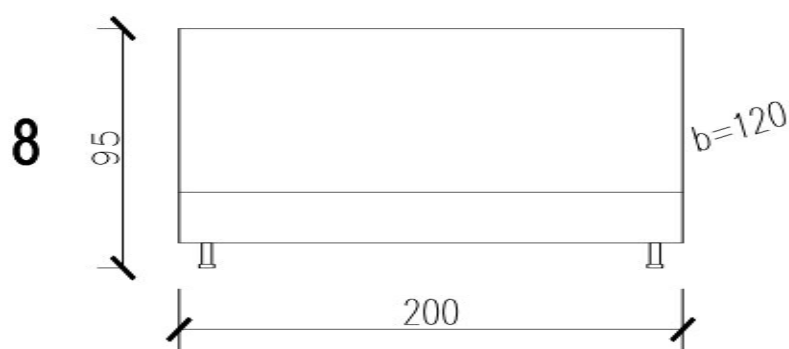
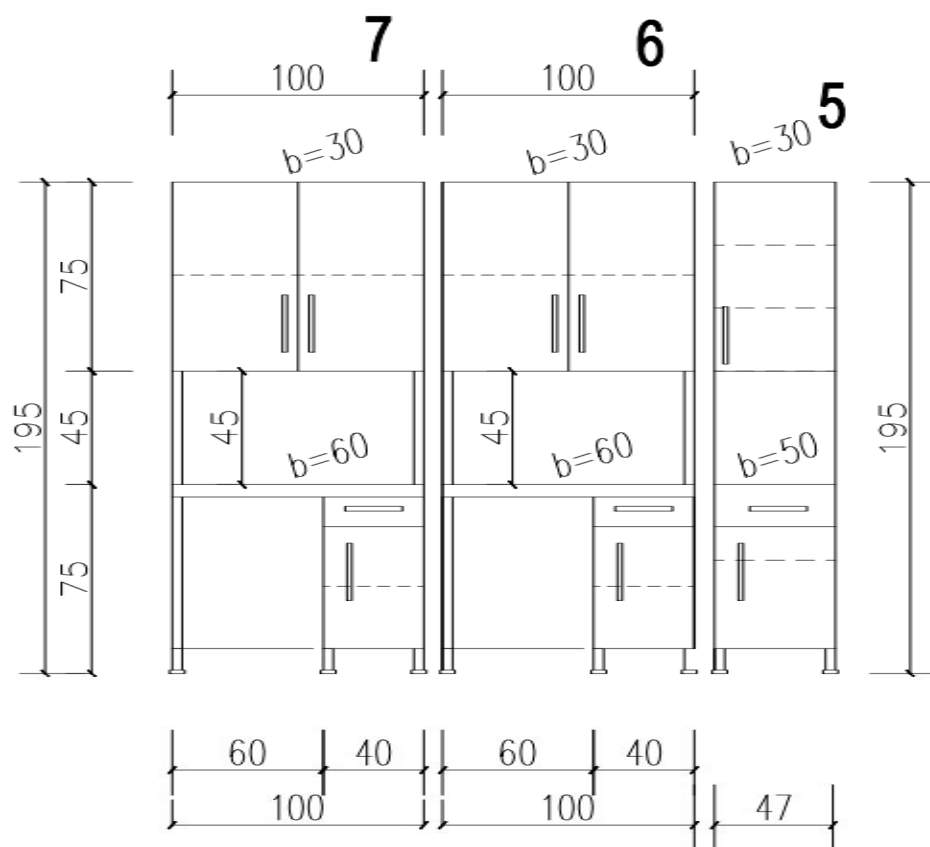

1223

Pokój Lekarski

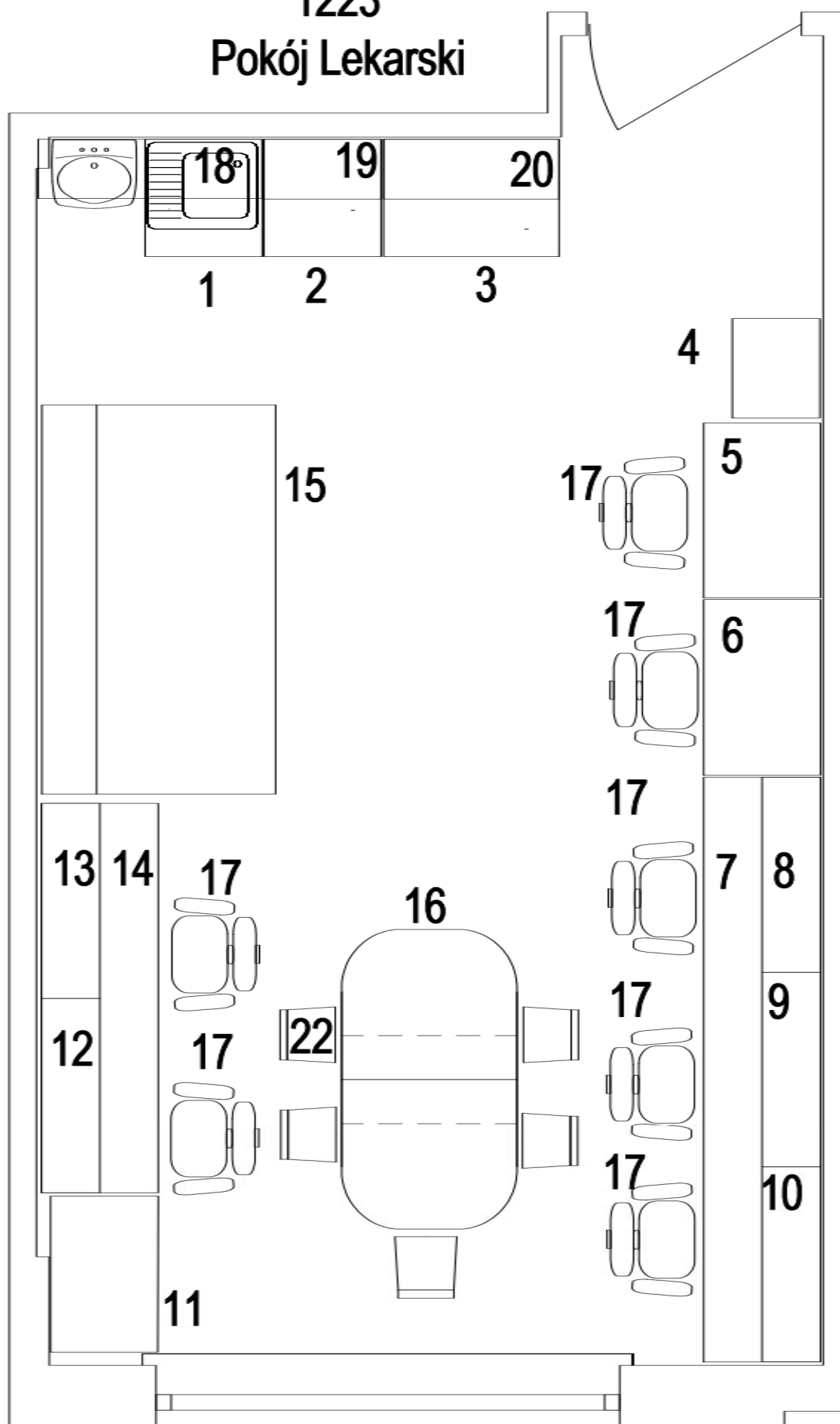

# ROZMIESZCZENIE I SCHEMATY MEBLI DLA 1H\_1

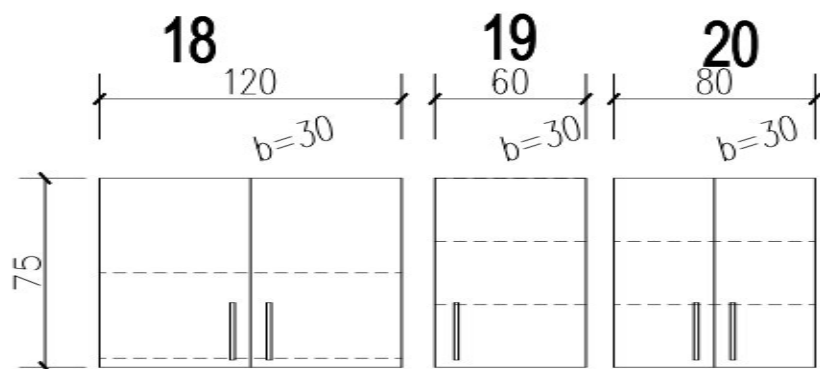

**1223**  
**Pokój Lekarski**

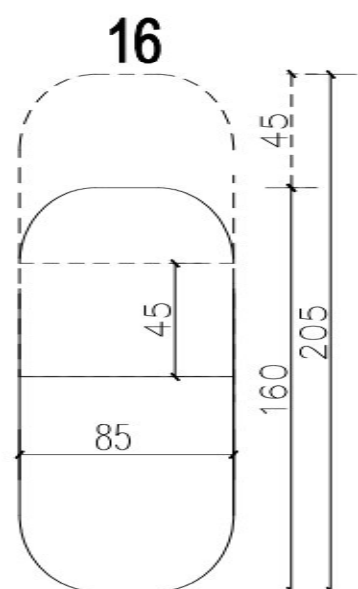
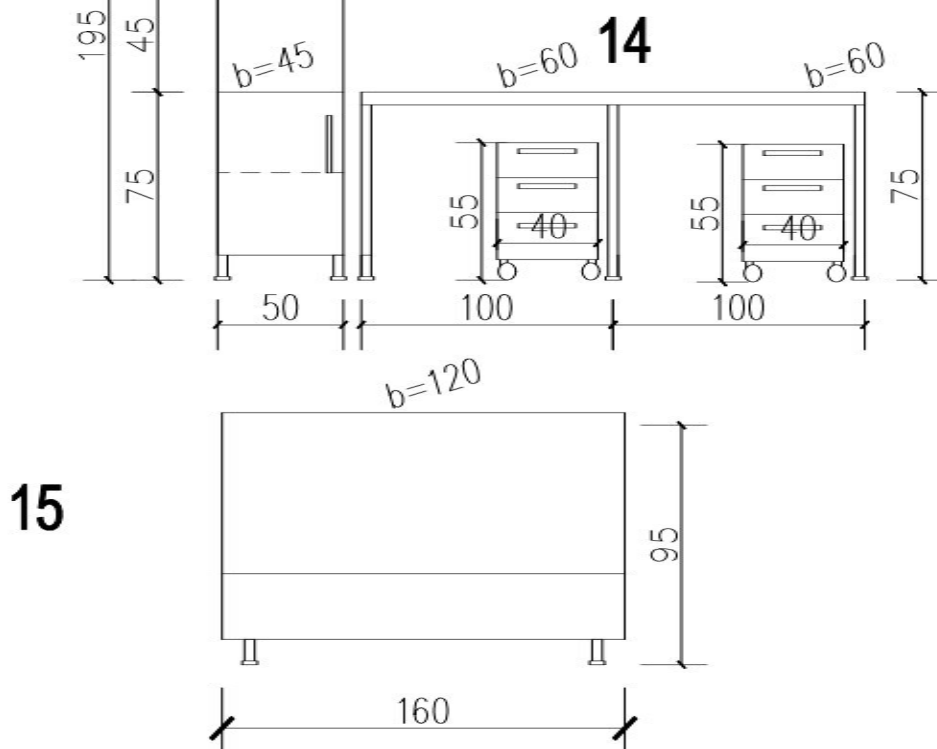
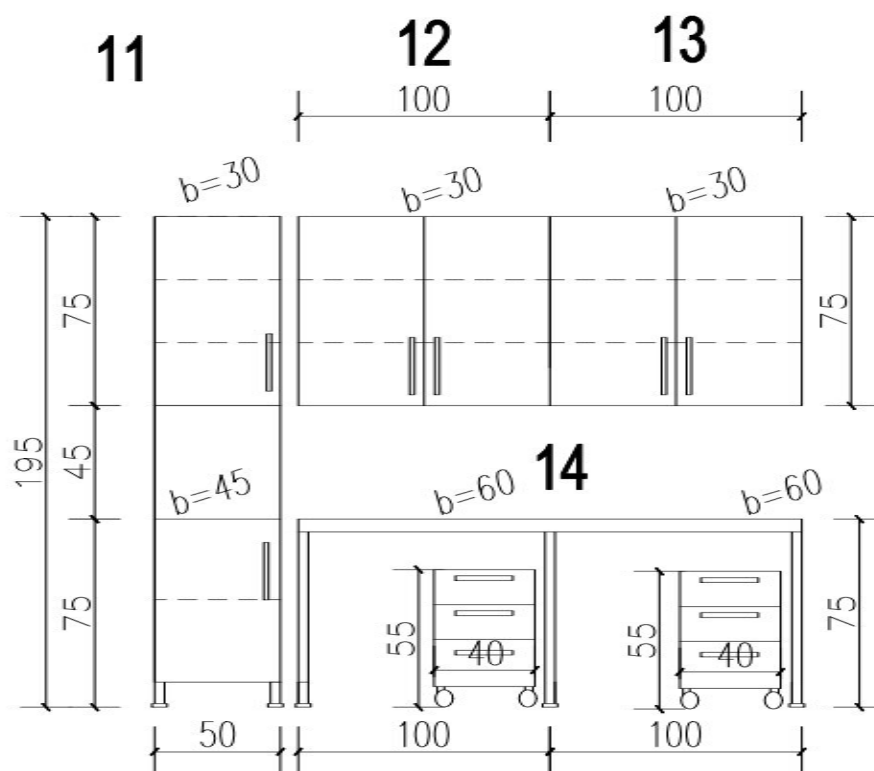
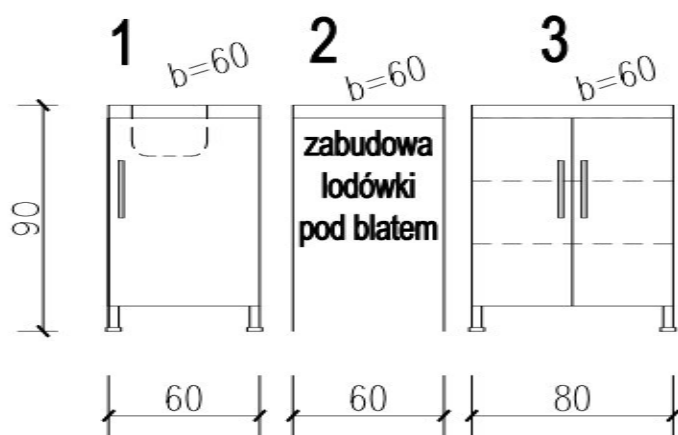

1223  
Pokój Lekarski

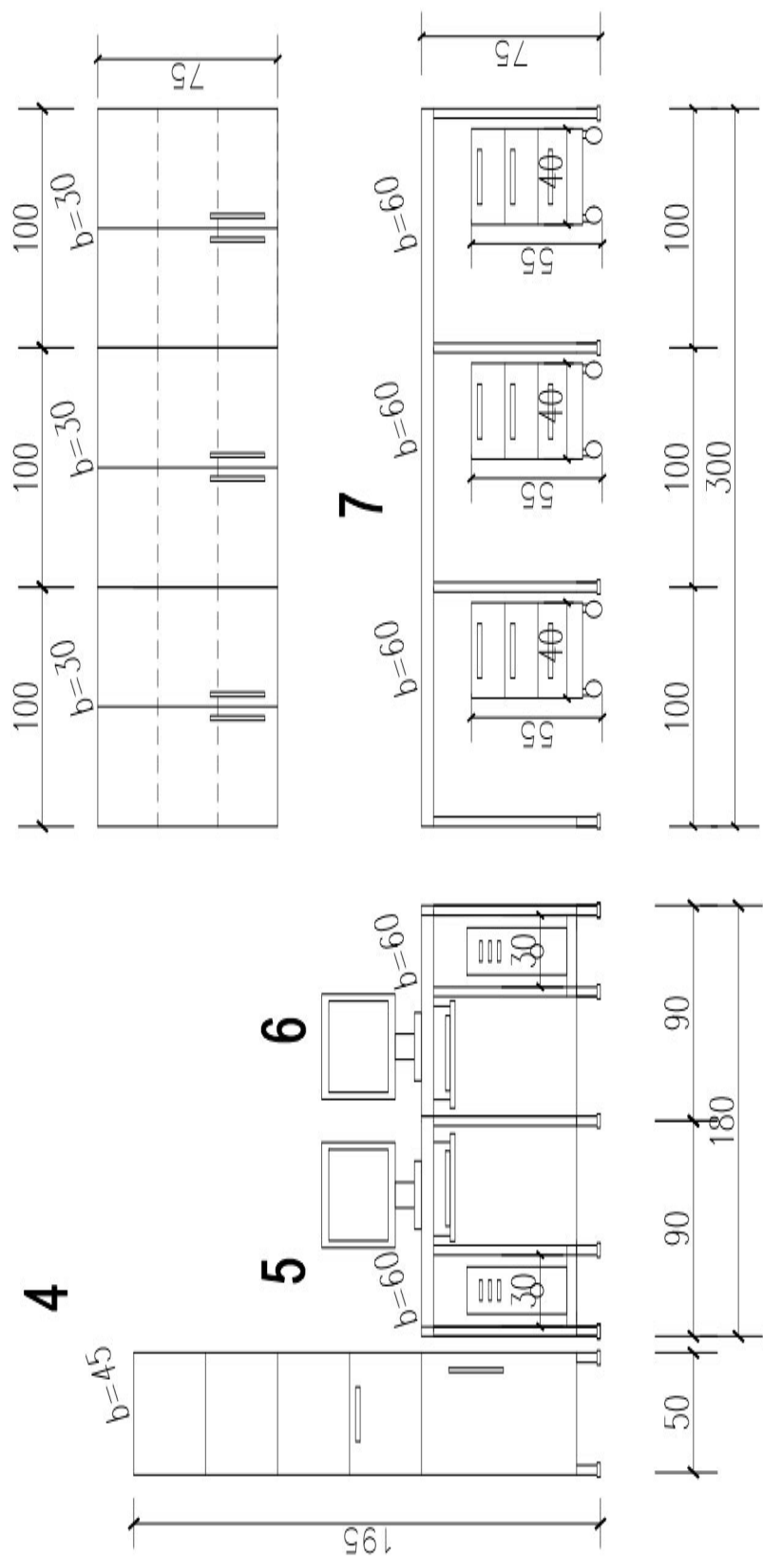

1995

# Śluza Umywalkowo-Fartuchowa

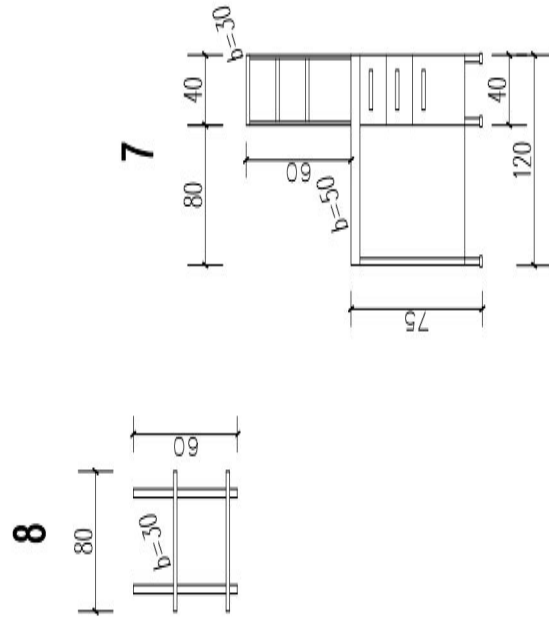
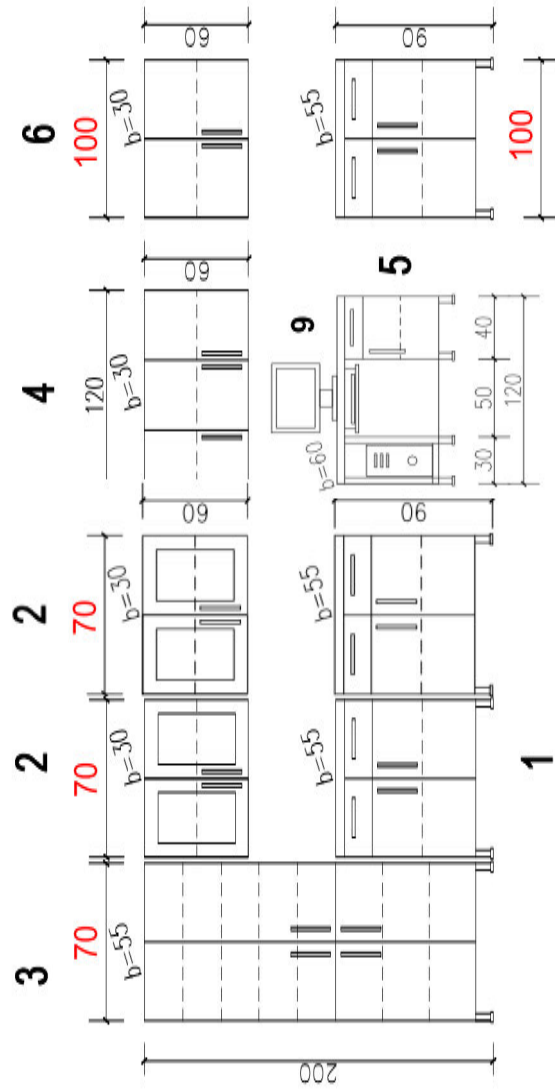
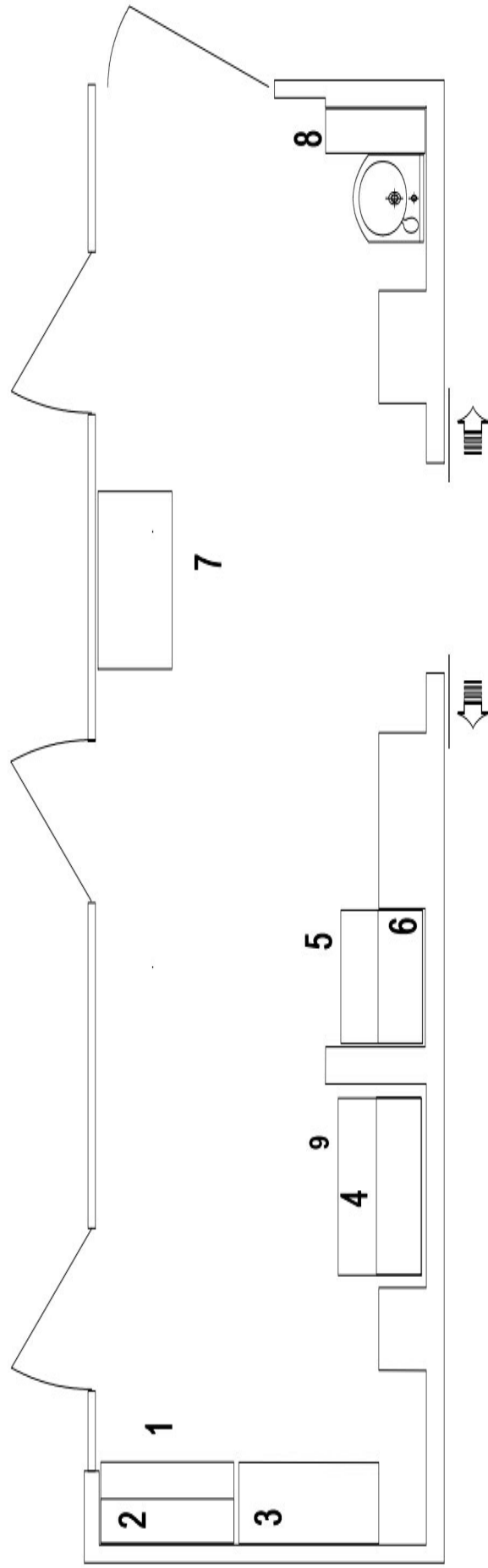

1186

Część Separatkowa 2 stanowiska

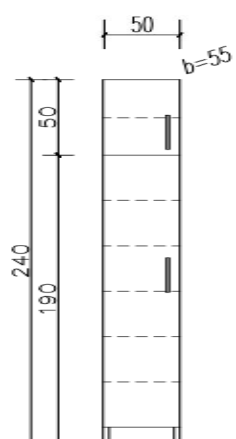
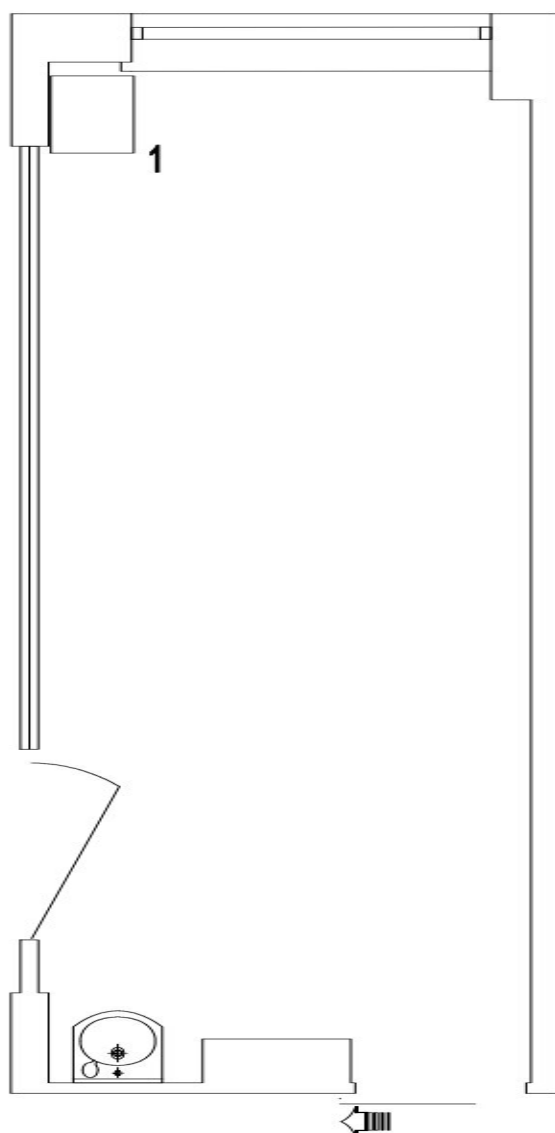

1187

Część Separatkowa 1 stanowisko

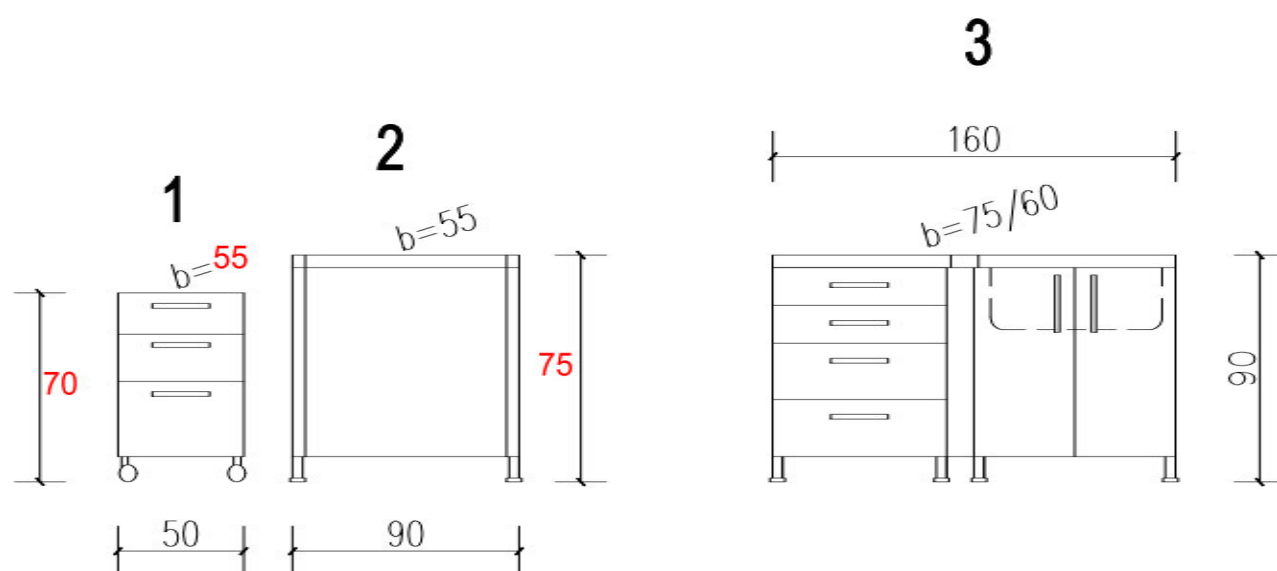
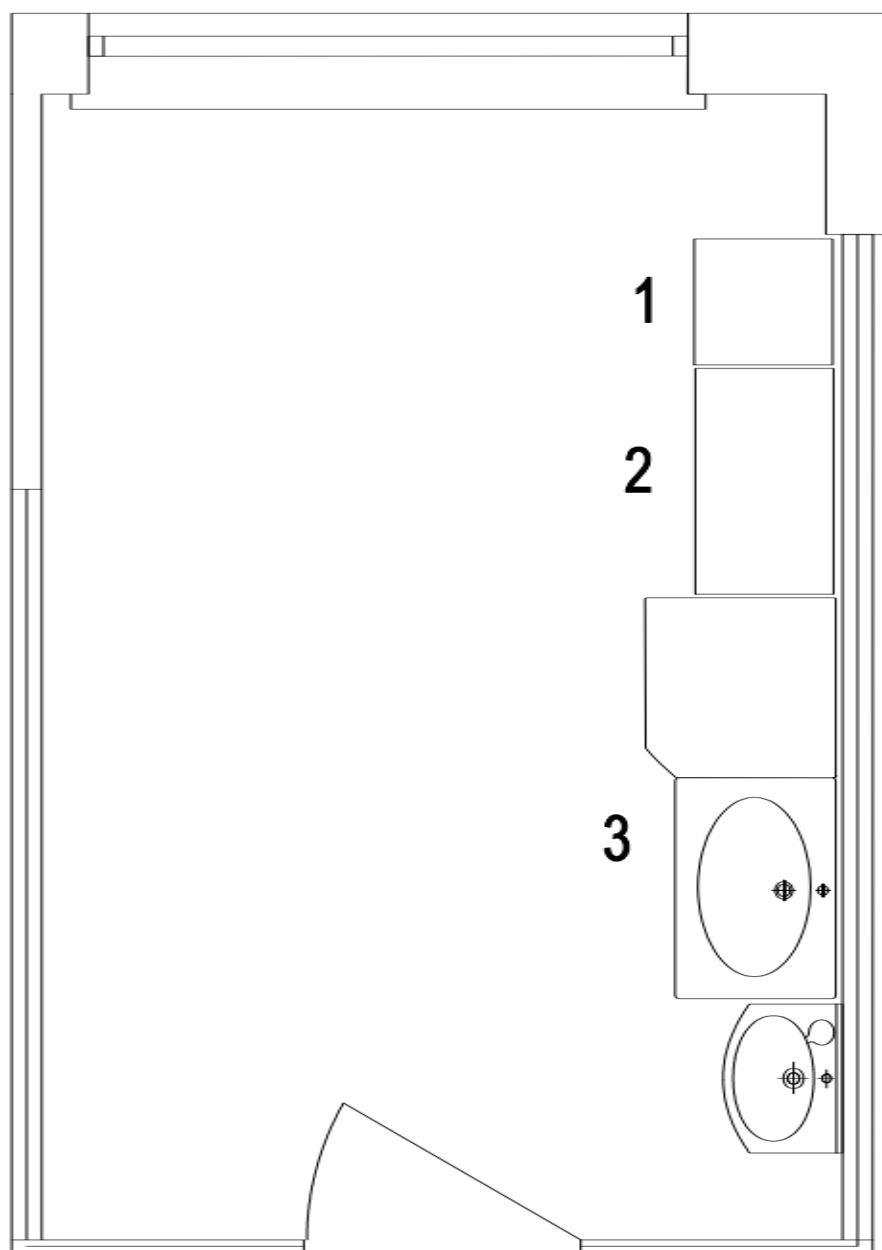

1188

Część Separatkowa 1 stanowisko

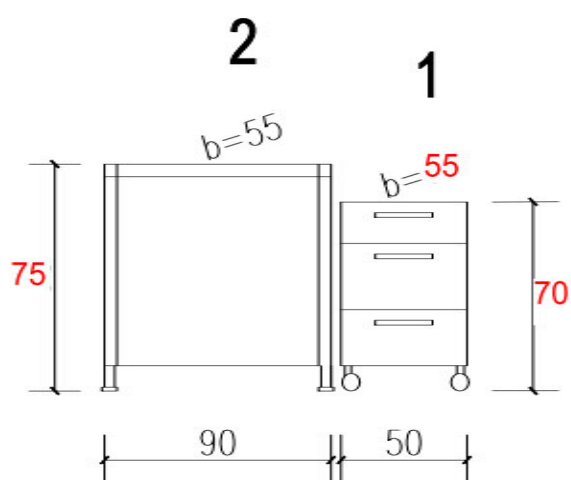
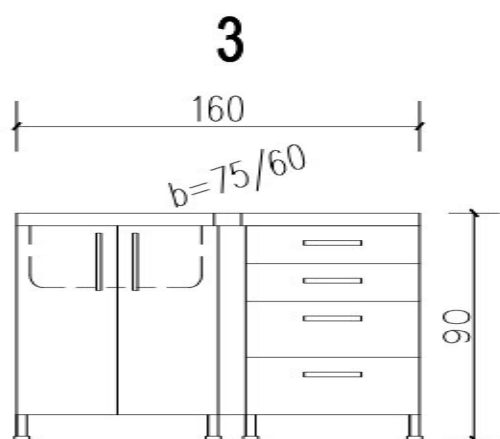
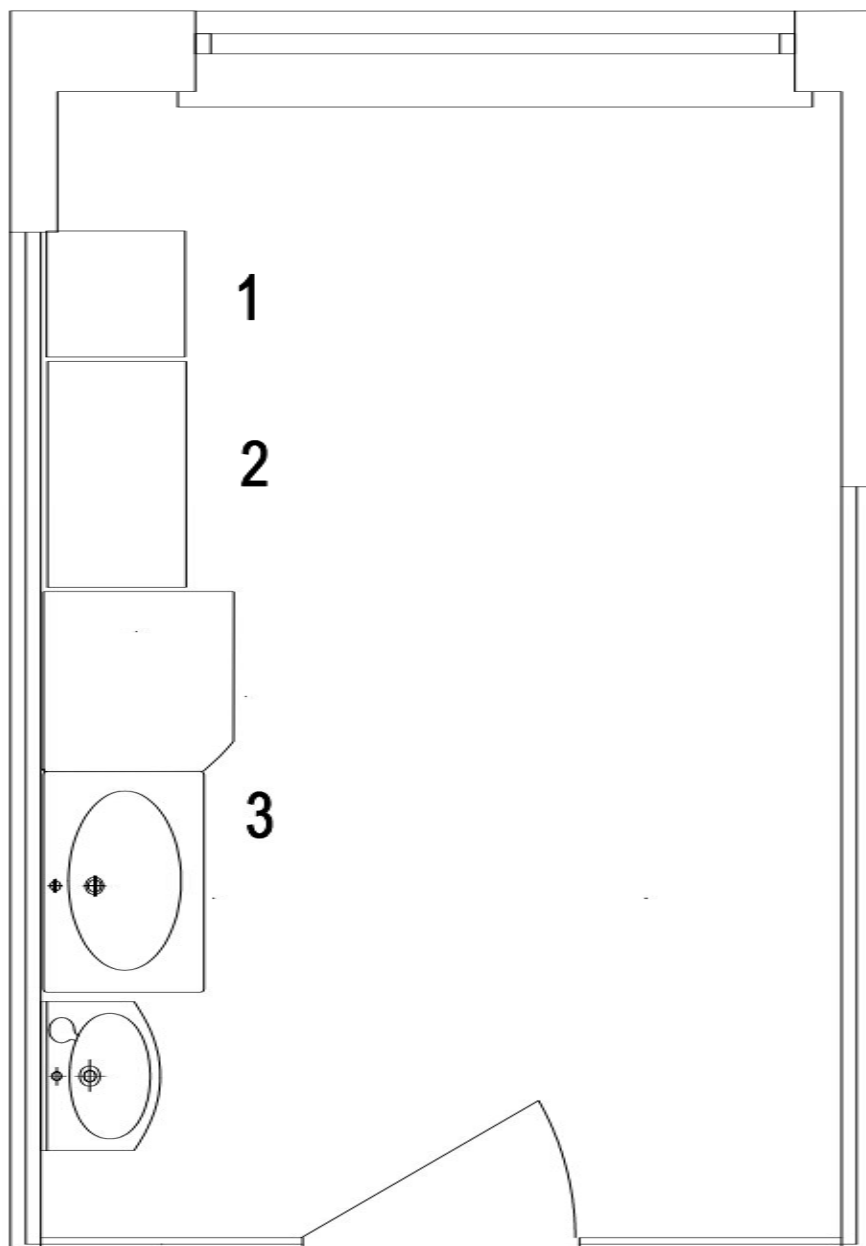



1189

Część Separatkowa 1 stanowisko

